

 Boundary

90 +/- Acres, 16-15-4, Merrick Co, NE

Merrick County, Nebraska, 90 AC +/-

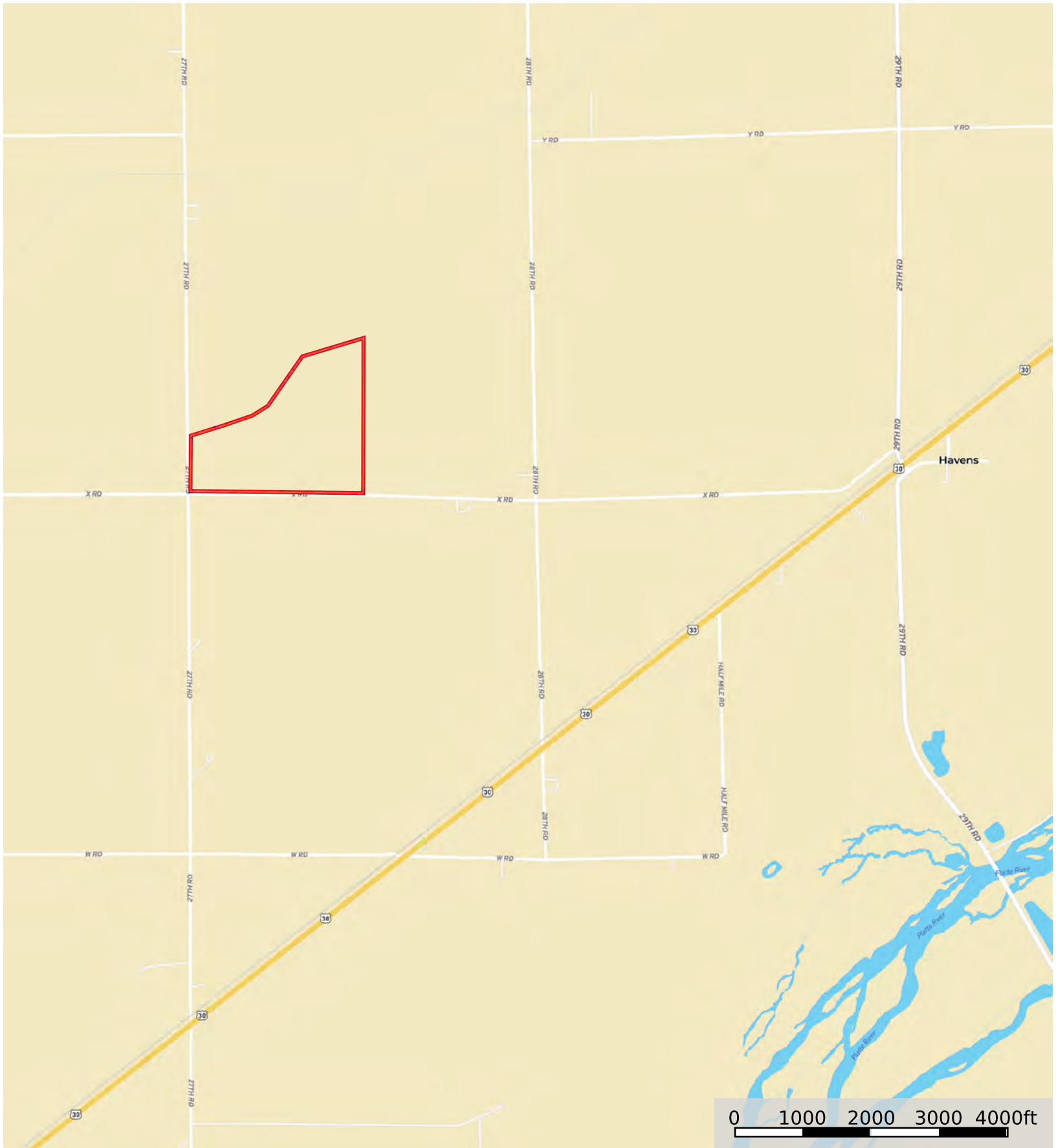

 Boundary

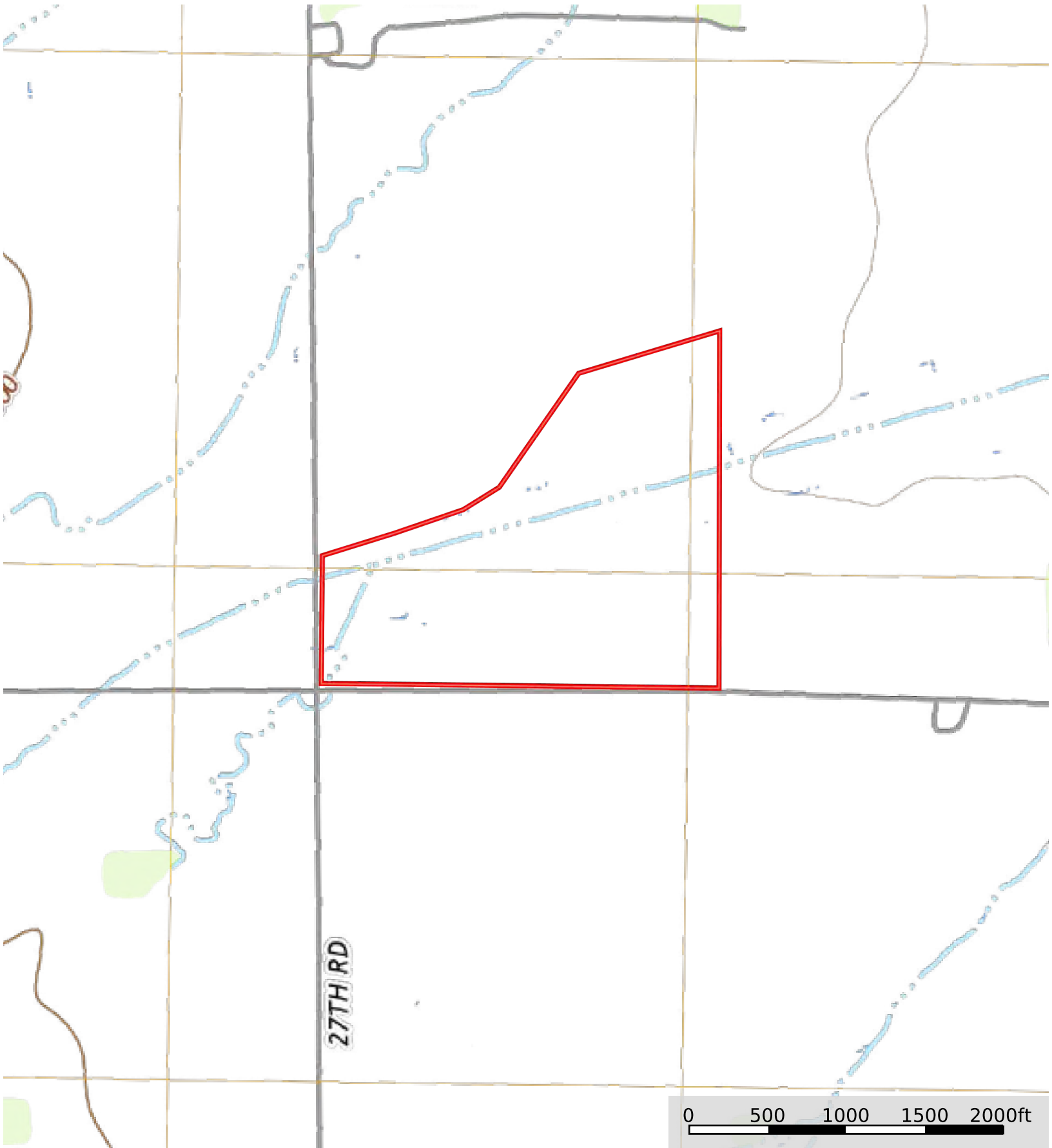

27TH RD

0 500 1000 1500 2000ft

 Boundary

|  Boundary 89.28 ac

SOIL CODE	SOIL DESCRIPTION	ACRES	%	CPI	NCCPI	CAP
6312	Barney loam, 0 to 2 percent slopes, frequently flooded	56.38	63.16	0	17	5w
8463	Gayville-Caruso complex, occasionally flooded	12.92	14.47	0	36	4s
8405	Alda sandy loam, occasionally flooded	11.21	12.56	0	33	3w
8587	Wann sandy loam, occasionally flooded	4.11	4.6	0	44	2w
8503	Lex loam, occasionally flooded	2.46	2.76	0	31	3w
8456	Fonner sandy loam, rarely flooded	2.09	2.34	0	41	3w
8531	Novina sandy loam, rarely flooded	0.11	0.12	0	59	2w
TOTALS		89.28(*)	100%	-	24.0	4.36

(*) Total acres may differ in the second decimal compared to the sum of each acreage soil. This is due to a round error because we only show the acres of each soil with two decimal.

