



146.33+/- Acres

IRRIGATED FARMLAND

Nance County, NE

Offered at \$834,081

Nice pivot-irrigated farm containing all class II soils consisting of mainly Lamo-saltine complex and Leshara silt loam soils.

This property is located close to multiple elevators & ethanol plants, and is open for the 2023 crop year.



KRAIG URKOSKI
FARM & RANCH SPECIALIST
CLARKS, NEBRASKA
308.548.8431
KRAIG.URKOSKI@AGWESTLAND.COM



PO BOX 1098, HOLDREGE, NE 68949 | 866-995-8067 | AGWESTLAND.COM



Total Acres: 146.33 +/-
Irrigated Acres: 110.60 +/-
Dryland Acres: 33.90 +/-
Other: 1.83 +/-

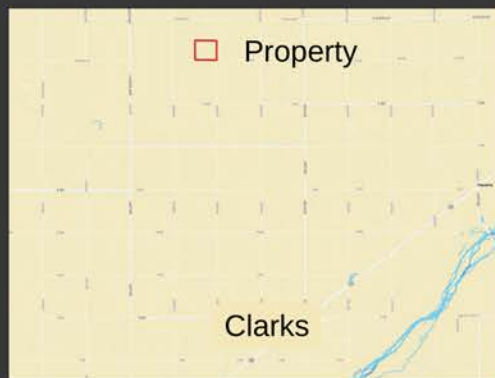

AERIAL MAP



Property Improvements:

- 1 - submersible well
- 2 - western landroller irrigation pumps with pulley heads
- 7 Tower early 2000 T&L pivot
- Roughly 510 ft. of 6" diamond plastic pipe with 30" gates, 1-6" shutoff, Isuzu Power unit, 500 gallon diesel fuel tank, 15 hp generator, 4 cylinder IH power unit

Legal Description:

Pt of Southeast 1/4 & Lots 3 & 4 Section 34, Township 16 North, Range 5 West, Nance County, Nebraska

FSA Info

Cropland Acres: 143.52
Corn: 143.5 Base Acres, 135 PLC Yield
Total Base Acres 143.5

Taxes

\$6,421.82

All owned mineral rights convey

Nance09

The information contained herein is as obtained by AgWest Land Brokers LLC—Holdrege, NE from the owner and other sources. Even though this information is considered reliable, neither broker nor owner make any guarantee, warranty or representation as to the correctness of any data or descriptions. The accuracy of such statements should be determined through independent investigation made by the prospective purchaser. This offer for sale is subject to prior sale, errors and omissions, change of price, terms or other conditions or withdrawal from sale in whole or in part, by seller without notice and at the sole discretion of seller. Readers are urged to form their own independent conclusions and evaluations in consultation with legal counsel, accountants, and/or investment advisors concerning any and all material contained herein. Maps are for illustrative purposes only and are not intended to represent actual property lines.