

165.70 +/- Acre Pivot Irrigated Farm Fillmore County



- ⇒ Nice laying pivot irrigated farm.
- ⇒ Located near several good grain markets.
- ⇒ Irrigation pivot owned by tenant.
- ⇒ Offers over 85% productive Crete and Butler silt loam Class II soils.
- ⇒ Open for the 2022 crop season.

Total Property Acres (Per Assessor): 165.70 +/-
Acres of Irrigation: 145.36 +/- Acres of Dryland: 16.32 +/-
Acres of Other: 4.02 +/-

Property Taxes - \$7,107.28

Legal Description - SW 1/4 in Section 19, Township 5 N, Range 1 W

Price- \$1,988,400.00

Directions: From Ohiowa travel south on Road 21 for 2 miles to Road W. Head west for 2 miles. The property will be on the northeast of the intersection of Road 19 and Road W.

Jeff Moon, ALC | Farm & Ranch Specialist | Holdrege, NE
308.627.2630 | Jeff.Moon@AgWestLand.com

AgWest Land Brokers, LLC | 415 W. 4th Ave. PO Box 1098
Holdrege, NE 68949 | 866-995-8067

AgWestLand.com





FSA Information:
Total Cropland Acres: 163.37
Corn: 122.9 Base Acres - 161 PLC Yield
Grain Sorghum: 6.2 Base Acres - 91 PLC Yield
Soybeans: 33.8 Base Acres - 41 PLC Yield
Total Base Acres: 162.9

Soils Map

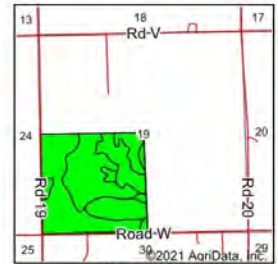
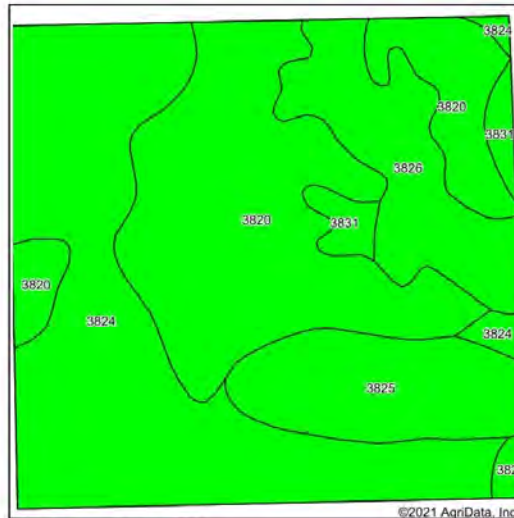

State: **Nebraska**
 County: **Fillmore**
 Location: **19-5N-1W**
 Township: **Franklin**
 Acres: **165.7**
 Date: **9/20/2021**



Soils data provided by USDA and NRCS.
 Area Symbol: NE059, Soil Area Version: 19

Code	Soil Description	Acres	Percent of field	SRPG Legend	Non-Irr Class *c	Irr Class *c	SRPG
3824	Crete silt loam, 0 to 1 percent slopes	62.50	37.7%		IIIc	IIIc	70
3820	Butler silt loam, 0 to 1 percent slopes	60.31	36.4%		IIW	IIW	74
3826	Crete silt loam, 3 to 7 percent slopes	19.88	12.0%		IIIe	IIIe	66
3825	Crete silt loam, 1 to 3 percent slopes	18.87	11.4%		IIe	IIe	68
3831	Crete silty clay loam, 3 to 7 percent slopes, eroded	4.14	2.5%		IIIe	IIIe	67
Weighted Average							70.7

*c: Using Capabilities Class Dominant Condition Aggregation Method

Irrigation and Well Information:

- Located in the Little Blue NRD and has certified irrigation rights for 135.79 acres.
 - G-003524, drilled in 1956, 1,000 gpm, static level 78 ft., pumping level 91 ft., well depth 193 ft., 60 HP electric well motor.

Equipment Information:

- Tenant owned pivot, underground pipe, electric well motor, and panel boxes.



The information contained herein is as obtained by AgWest Land Brokers, LLC—Holdrege, NE from the owner and other sources. Even though this information is considered reliable, neither broker nor owner make any guarantee, warranty or representation as to the correctness of any data or descriptions. The accuracy of such statements should be determined through independent investigation made by the prospective purchaser. This offer for sale is subject to prior sale, errors and omissions, change of price, terms or other conditions or withdrawal from sale in whole or in part, by seller without notice and at the sole discretion of seller. Readers are urged to form their own independent conclusions and evaluations in consultation with legal counsel, accountants, and/or investment advisors concerning any and all material contained herein.